

**CHEM-PRUF P-SERIES
SINGLE FRAME ONLY
ORDER FORM**

HEAVY DUTY
EXTREME DUTY
FIRE RATED
20 MIN ___ 30 MIN ___ 45 MIN ___
60 MIN ___ 90 MIN ___

WIND LOAD RATED
DESIGN PRESSURE: PSF

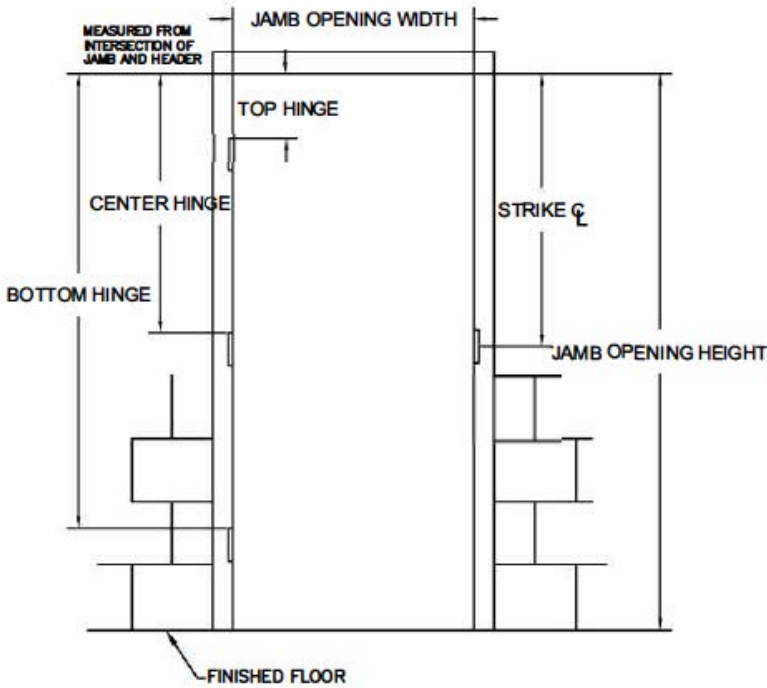

HARDWARE PREPARATIONS

4-1/2" MORTISE HINGES
OF HINGES: 3 4 5
STD WEIGHT
HEAVY WEIGHT

5" MORTISE HINGES
OF HINGES: 3 4 5
STD WEIGHT
HEAVY WEIGHT

CONTINUOUS HINGE REINFORCEMENT

4-7/8" ANSI STRIKE PREP

DEADBOLT STRIKE PREP

RIM SURFACE STRIKE REINFORCEMENT

CLOSER REINFORCEMENT RA/PA

SURFACE OH HOLDER/STOP REINFORCEMENT

CONCEALED OH HOLDER/STOP REINFORCEMENT

OTHER
NOTES:

COLOR

POLAR WHITE
CASHEW TAN
MIST GRAY
PRIMER, FOR FIELD PAINTING
OTHER

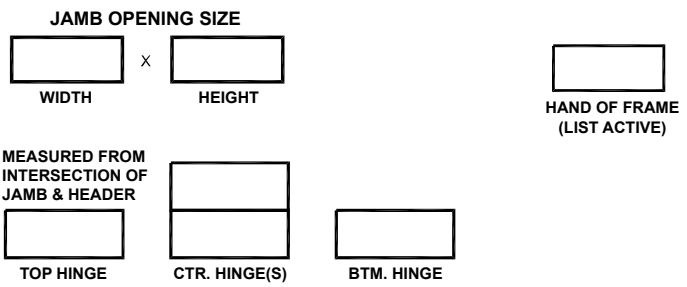

ROUGH OPENING: OVERALL FRAME PLUS 1/4" ALL AROUND TO ALLOW FOR FRAME SHIMS.

CUSTOMER NOTES:

* All colors have a semi-gloss finish

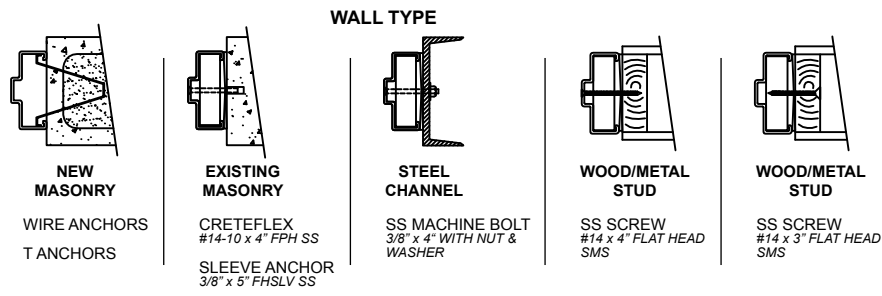
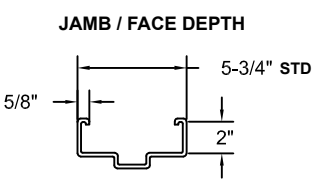
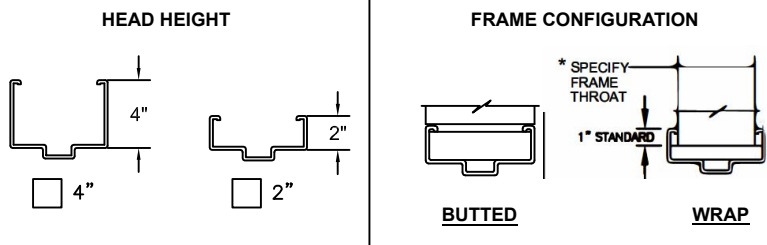

CHEM-PRUF

5224 FM 802 Brownsville, TX
78521 P: 800.444.6924
E: frporders@senneca.com
www.chem-pruf.com

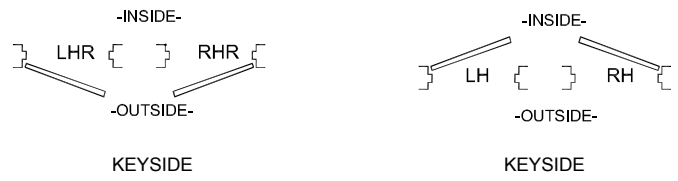

**CHEM-PRUF P-SERIES
SINGLE FRAME ONLY**

CUSTOMER:

PROJECT:

DOOR MARK: